

66220

Location of Wastewater Connection



Public Works Maintenance
1820 Roosevelt Blvd.
Eugene, Oregon 97402
(541) 682-4800

Property Information

Address 2810 Taylor St.
Map and Tax Lot _____ Owner Patricia Lyon
Building Type: SFD Duplex Multi-Family Commercial Industrial

Permit Information

Permit No. 18-08188-01 Date of Issue 10-18-18
Contractor/Plumber Peterson Plumbing Pipe Material Sch. 40 (16) Pipe Diameter 4"
 Right of Way Cut Permit Required System Development Charge
Installation Date 10-22-18 Inspected By LaCasse

Permission granted to attach private sewer connection to public sewer in conformance to City standards and specifications.

Public Wastewater Information

Index Page No. 125 Segment No. 3101 3120 Inspected By _____
Upstream Downstream Contract No. _____

TWO WORKING DAYS BEFORE YOU DIG, CALL UTILITY ONE-CALL SERVICE AT 1-800-332-2344

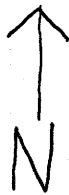

W. 28th

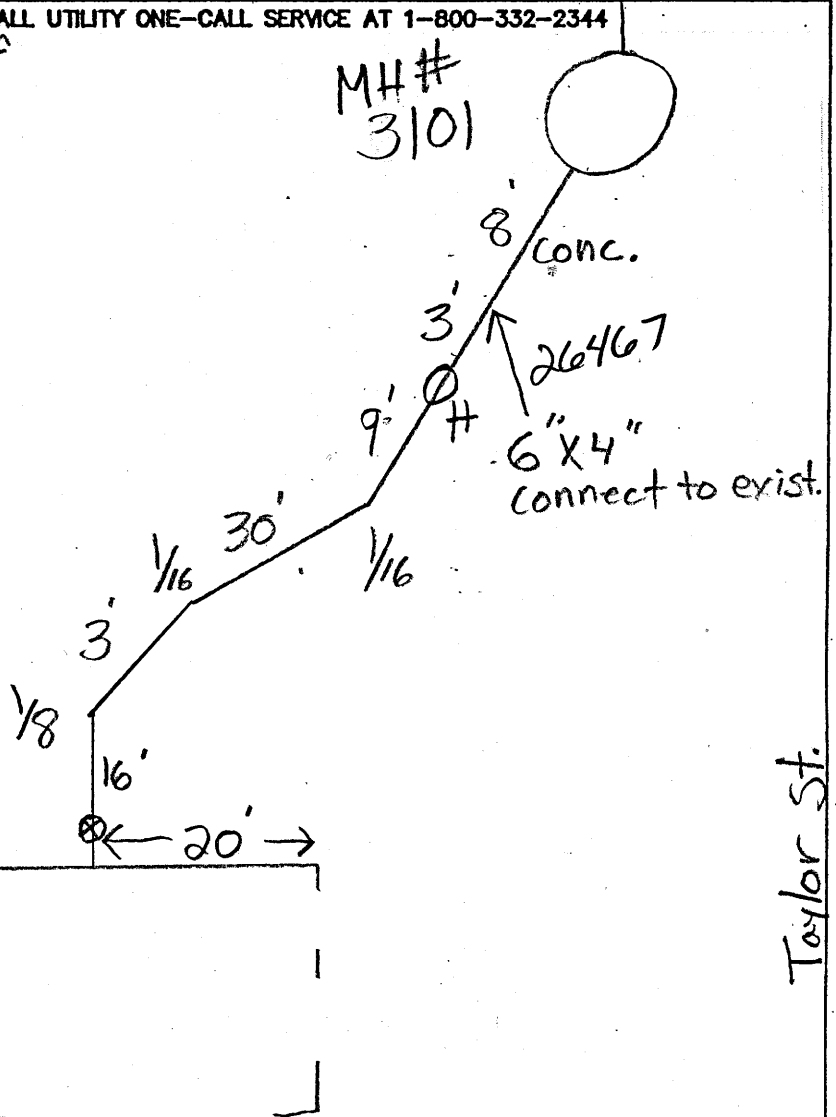

Taylor St.